

## MODELS-631, 632, 633, 634 All Stainless Steel Pressure Gauges

## Mechanical Pressure Measurement

600 series gauges are suitable for corrosive environments in chemical, petro-chemical, refining, power, marine, food and pharmaceutical processing applications.

### SPECIFICATIONS

#### Case

AISI 304 Stainless Steel  
Bezel Polished Stainless Steel (Bayonet type)  
Weatherproof Construction to IP66 Ingress Protection rating

#### Socket + Element

AISI 316 Stainless Steel

#### Pressure Connection Thread

$\frac{1}{8}$ ",  $\frac{1}{4}$ ",  $\frac{3}{8}$ ",  $\frac{1}{2}$ " NPT, BSP, BSPT

#### Blowout Protection

Top Mounted Rubber Disk

#### Movement

Stainless Steel

#### Dial

White Aluminium (Black Printing)

#### Pointer

Black Aluminium

#### Window

Sheet Glass

#### Standard Size

63, 100, 150mm (2.½", 4", 6")

#### Accuracy class

63, 100 & 150mm  $\pm 1\%$  of span

#### Scale Range

Vacuum to 1,400 bar (20,000 psi) (63mm gauge)  
Vacuum to 2,500 bar (36,000 psi) (100 & 150mm gauges)



Model-632 (Standard)

### Optional Extras

AISI 316 Stainless Steel case  
White Plastic Dial (Black Printing)  
Micro adjustable pointer /Black finish  
Monel to Nace Mr-01-75 wetted parts  
Other pressure connections (Including high pressure)  
Laminated safety glass / Perspex window  
Customer logo  
Liquid filling  
Vibragauge®  
Snubbagauge®

*Further options on request*

Surface Mounted  
Model - 631

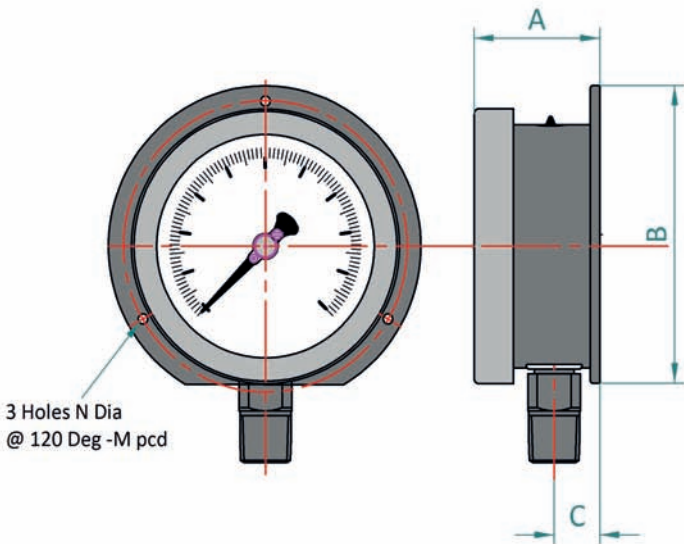

Direct Mounted (Standard)  
Model - 632

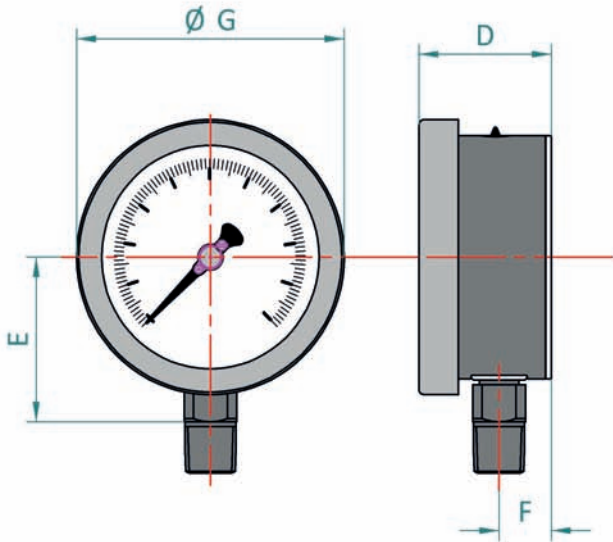

Flush Mounted Screw Fixing  
Model - 633

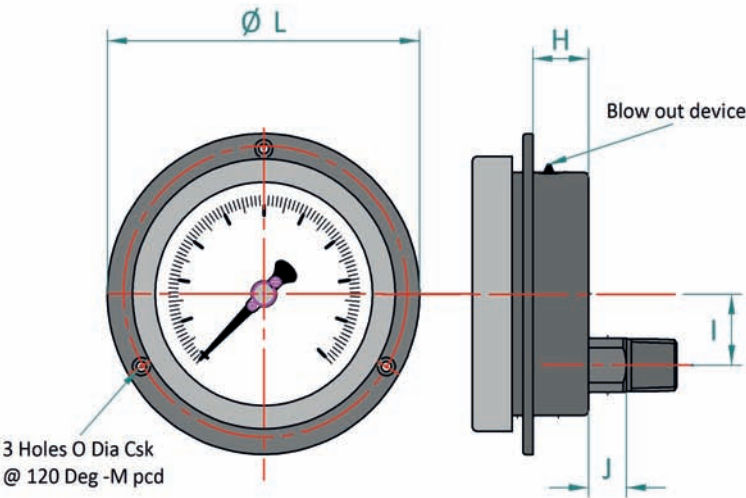

Flush Mounted Clamp Fixing  
Model - 634

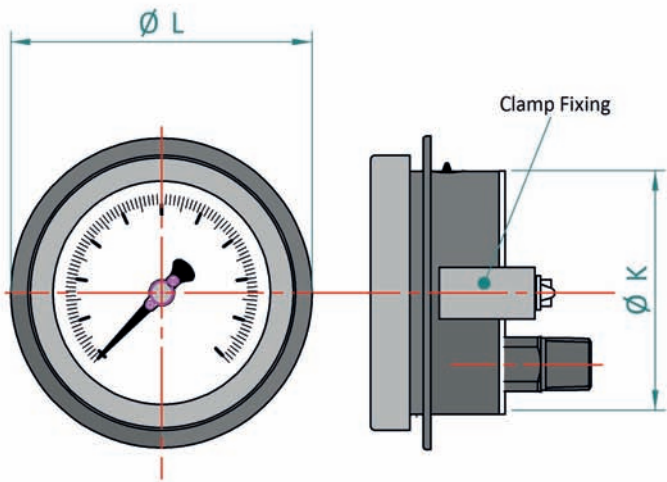

Dim mm																
Diameter	A	B	C	D	E	F	G	H	I	J	K	L	M	N	O	Panel Cutout
2.5" ( 63mm)	39	78.5	12.5	31	42	9.5	68.5	21.5	18	10	62	85	75	3.5	3.8	66
4" (100mm)	50.5	121	17	48.5	67	15	112	24.5	32	18	99	132	118	6	6	106
6" (150mm)	50.5	174	17	48.5	93	15	162	24.5	32	18	148	185	168	5.8	5.8	153

How to order pressure gauges: State the following.					
Pressure gauge model	Nominal size	Scale Range	Size of connection	Pressure Medium	Optional extras required

WARNING: Misuse or misapplication of these products is potentially dangerous and could lead to personal injury. Do not use without first reading and understanding the Installation and Operation Instructions contained within our Guidance on use of Equipment booklet. If in doubt consult Stewarts.

Specifications and dimensions given in this leaflet represent the state of engineering at the time of printing. Engineering modifications may take place without prior notice.